

**VERSATILE
4-IN-1
DISINFECTANT
CLEANER**

- Simplify procedures with one product across multiple spaces and surfaces.
- Speed up cleaning by reducing steps and achieving quick disinfection!
- Promote cleanliness, health and positive user experience.



EPA Reg. No. 1677-272 and 1677-273 (RTU)

ELIMINATING RESIDUE AND STREAKS:

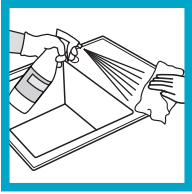

Use a clean microfiber cloth for best performance, as paper towels (or other disposable wipes) may leave behind particles or residue. **Do not use fabric softener** when cleaning microfiber cloths.



For mirror and glass application, **spray clean microfiber cloth instead of the mirror** for a streak-free finish.

FIGHTING GERMS AND ODORS ON SOFT SURFACES:



Sanitizes, disinfects¹ and removes odors, but is not a stain remover. **Before using on soft surfaces**, test the product in an inconspicuous area. Avoid using on white, light-colored or cotton fabrics.

ACHIEVING THE BEST RESULTS:

USE ON MULTIPLE SURFACES ACROSS OPERATION



PUBLIC SPACES

including windows, glass and high-touch surfaces

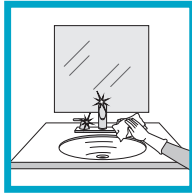

RESTROOMS

including mirrors, fixtures and sinks

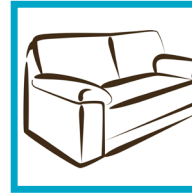

**SOFT-SURFACE
DISINFECTANT¹**

including upholstered furniture

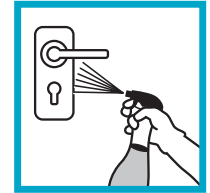

**HIGH-TOUCH
HARD SURFACES**



! WAIT BEFORE YOU WIPE
Surfaces must stay wet for the full contact time to achieve disinfection and kill pathogens that make people sick.

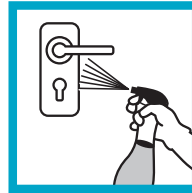

! FOCUS ON GERM HOT SPOTS
High-touch surfaces are more likely to harbor germs that may make people sick. Prioritize disinfection of these surfaces.

¹Rapid Multi Surface Disinfectant Cleaner is EPA registered (EPA Reg No 1677-272 for the concentrate and EPA Reg No 1677-273 for the RTU). Refer to the product label for complete listing of efficacy claims and directions for use.

² Norovirus/Influenza/other viruses: When used according to label directions; EPA Reg. No. 1677-272 and 1677-273 (RTU).